

HYDROCYCLONE SAND SEPARATORS

SEPARATE SAND AND SOLID MATTER FROM WATER WITH 90% OR BETTER EFFICIENCY

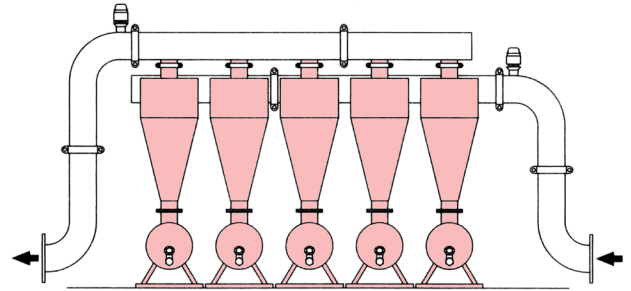

Hydrocyclone with Sedimentation Tank



PRODUCT ADVANTAGES

- Conical shape accelerates the velocity of the water increasing centrifugal forces and maximizing separation.
- Easy to operate and maintain with no moving parts or screens.
- No headloss build-up or clogging during separation.
- Specially designed rubber cone/insert protects the neck from erosion and increases separation.
- Large holding capacity of sedimentation tank reduces flushing frequency.
- Maximum anti-corrosion protection with durable and long-lasting coating materials.

APPLICATIONS

- For separation of sand and other solid matter from water
- Protection of valves and irrigation systems from damage/abrasion caused by sand and other solid matter
- Pre-filtering of water with high loads of sand before gravel, disc and screen filters

SPECIFICATIONS

- Maximum Recommended Working Pressure: 120 psi
- Recommended Headloss for Effective Operation: 3 - 8 psi
- Water Inlet and Outlet: Horizontal and Vertical
- Hydrocyclone End Connections: Thread, Flange and Groove
- Sedimentation Tank Connections:
Thread - 3" and 4" sizes
Groove - 6" and 8" sizes
Flange - 12", 16", 20", 24" and 30" sizes
- Rubber Insert not included on 3" and 4" sizes
- Protective Coating: Polyester Applied Electrostatically and Oven Cured on a Zinc-Phosphate Layer

HYDROCYCLONE MESH/MICRON

MESH	120	140	180	200	270	325	600
MICRON	130	105	90	75	53	44	25

PARTICLE SIZE SEPARATION

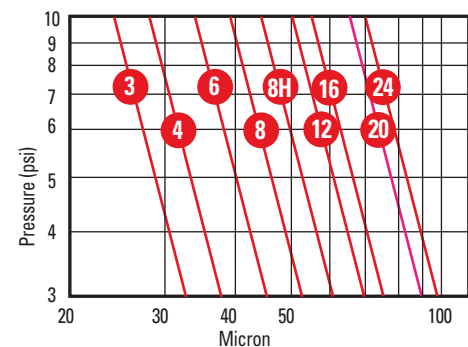

NOTE: The Particle Size Separation chart is based on sand with a specific gravity of 2.7 gr/cm.

HYDROCYCLONE SAND SEPARATORS

DESCRIPTION OF OPERATION

Based on the centrifuge principle, the particles are spun against the outside wall of the Hydrocyclone and gravitate towards the bottom into the underflow chamber (sedimentation tank) while clean liquid moves upward to the center of the spiral, towards the top outlet. The velocity at which the water flows through the Hydrocyclone determines the efficiency at which the particles are separated from the water.

- Normal working conditions are achieved when headloss on the Hydrocyclone is not less than 3 psi. A headloss of less than 3 psi will reduce the separation efficiency and a headloss of more than 8 psi might induce increased erosion.
- The flow during operation of the system needs to be fairly constant to ensure effectiveness of separator.

HEADLOSS (Flow vs. Pressure)

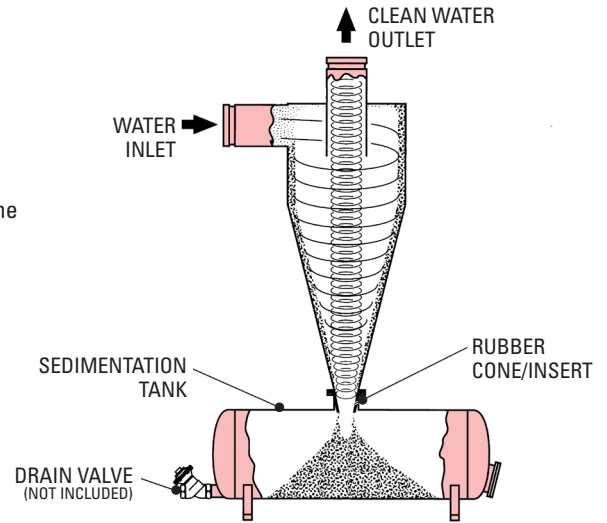
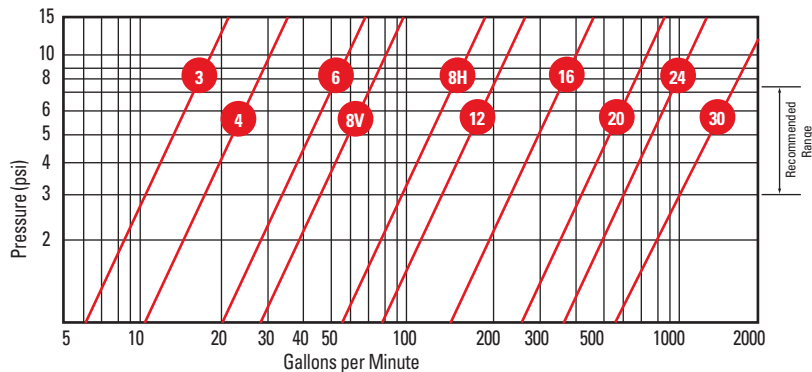

READING THE HEADLOSS CHART:

Find your system flow rate and move vertically up the chart until you intersect within the recommended range. This indicates a particular hydrocyclone size. If your flow rate does not intersect within the recommended range, two smaller units in combination are suggested. If material to be removed is extremely fine, use a higher headloss and/or multiple hydrocyclone units of a smaller size. A smaller hydrocyclone can remove finer particles than one with a larger diameter.

HYDROCYCLONE ORDERING INFORMATION

ITEM NUMBER	MODEL NUMBER	SIZE	FLOW RANGE (GPM)	SEDIMENTATION TANK
70020-003200	24HC3	3"	9 - 15	24ST002L
70020-004315	24HC4	4"	15 - 33	24ST002L
70020-003420	24HC6V	6"	33 - 53	24ST010FLV2
70020-003520	24HC8V	8" V	48 - 75	24ST010FLV2
70020-003650	24HC8HV	8" H	80 - 150	24ST010FLV2
70020-004343	24HC12F6	12"	150 - 230	24ST060F6
70020-003960	24HC16F6	16"	230 - 360	24ST120F6
70020-004160	24HC20F8	20"	430 - 700	24ST220F8
70020-004355	24HC24F8	24"	615 - 1,000	24ST220F8
70020-004360	24HC30F8	30"	1,000 - 1,600	24ST220F8

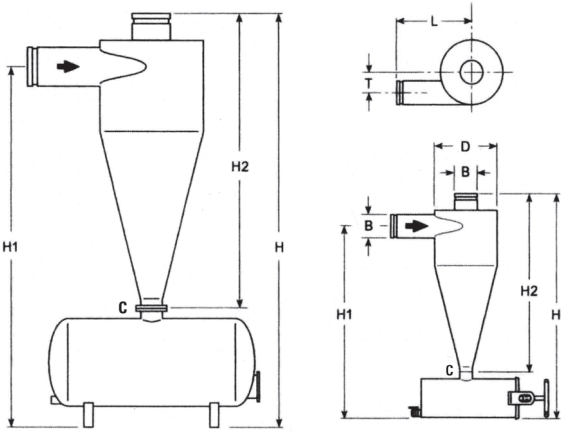

DIMENSIONS & WEIGHT

MODEL	B	C	D	H	H1	H2	L	T	WEIGHT	WEIGHT **
24HC3	¾" TH	½" TH	3"	16"*	12.6"	11.2"	4.7"	1.2"	18 lbs.	31 lbs.
24HC4	1" TH	½" TH	4"	18"*	15"	13.6"	5.5"	1.6"	20 lbs.	44 lbs.
24HC6V	1½" TH	3" GR	6"	26"*	20.3"	16.7"	9.5"	2.4"	40 lbs.	76 lbs.
24HC8V	2" GR	3" GR	8"	29"*	22.6"	20.9"	11.6"	3.2"	44 lbs.	80 lbs.
24HC8HV	3" GR	3" GR	8"	33"*	26"	24.6"	11.8"	2.6"	60 lbs.	96 lbs.
24HC12F6	4"/3" FL	6" FL	12"	52"	44.5"	28.5"	19.7"	4.1"	146 lbs.	221 lbs.
24HC16F6	4" FL	6" FL	16"	68"	58.3"	38.2"	23.6"	5.7"	276 lbs.	420 lbs.
24HC20F8	6" FL	8" FL	20"	75"	63.4"	45.3"	23.6"	6.7"	379 lbs.	571 lbs.
24HC24F8	6" FL	8" FL	24"	85"	73.2"	55.3"	23.6"	8.7"	452 lbs.	644 lbs.
24HC30F8	8" FL	8" FL	30"	111"	93"	75.8"	27.6"	10.4"	770 lbs.	962 lbs.

* Height for sedimentation tank without legs

** Weight for sedimentation tank and hydrocyclone

TH = Thread GR = Groove FL = Flange

SEDIMENTATION TANK ORDERING

ITEM NUMBER	MODEL NUMBER	TANK CAPACITY
70020-004420	24ST002L	.50 GALLONS
70020-004820	24ST010FLV2	2.50 GALLONS
70020-004920	24ST060F6	16 GALLONS
70020-005050	24ST120F6	32 GALLONS
70020-005110	24ST220F8	58 GALLONS



NETAFIM USA
 5470 E. HOME AVE.
 FRESNO, CA 93727
 CS 888 638 2346
 F 800 695 4753
www.netafimusa.com