

# NETAFIM USA PRODUCT UPDATE

APRIL 2010

## LOW PRESSURE SPINE UPGRADE KIT ALLOWS FILTER FLUSHING AT 30 psi FOR 2" & 3" DISC-KLEEN AND GALAXY DISC-KLEEN FILTERS

Netafim is now offering a Low Pressure Spine Upgrade Kit for existing Disc-Kleen filters. Retrofitting to the low pressure spine allows the filter to flush at 30 psi instead of 40 psi - saving energy costs. A lower flushing pressure maintains water flow to the field during the flushing cycle ensuring higher uniformity.

### LOW PRESSURE SPINE UPGRADE KIT COMPONENTS

| ITEM NUMBER  | MODEL NUMBER   | DESCRIPTION               | PRICE EACH |
|--------------|----------------|---------------------------|------------|
| 70620-006010 | 25AP25066224G  | Green Butterfly Nut       | \$16.50    |
| 70620-006452 | 25AP25300217   | Low Pressure White Piston | \$23.00    |
| 70620-004106 | 25AP50032115   | O-Ring                    | \$4.50     |
| 70620-002366 | 25AP5044002886 | Low Pressure Light Spring | \$36.00    |

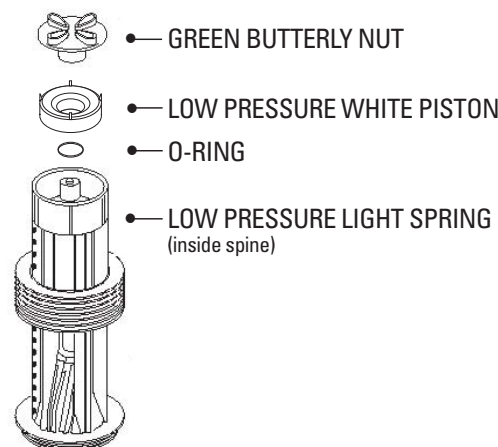

### 2" DISC-KLEEN AND GALAXY FILTERS

- From 2000-2005, filters used a stiff spring and it must be changed to the low pressure light spring.
- From 2005-2009, filters used a light spring and it does not need to be changed.
- Identifying a stiff spring from a light spring? When the old piston is removed from the spine and there is a triangular plate with 3 screws, then the spring below that piece is a light spring. If there is a round plate with 3 screws, then it's a stiff spring and needs to be replaced.

### 2" DISC-KLEEN & GALAXY - LOW PRESSURE SPINE UPGRADE KIT

| ITEM NUMBER  | MODEL NUMBER  | DESCRIPTION              | PRICE EACH |
|--------------|---------------|--------------------------|------------|
| 70041-000572 | 25APLSPINEKIT | Single Spine Upgrade Kit | \$80.00    |

### ORDERING EXAMPLE:

- Galaxy 3 unit from 2003 (need light spring)  
Order (15) Single Spine Upgrade Kits  
15 x \$80.00 = \$1,200.00 total
- Galaxy 3 unit from 2006 (light spring)  
Order (15) each of the Green Butterfly Nut,  
Low Pressure White Piston and O-Ring  
15 x \$44.00 = \$660.00 total

### 3" DISC-KLEEN FILTERS

- All filter spines must be upgraded.
- An Accelerator Relay must be added to each backflush valve to maintain a short valve transition from filtration to flushing mode (Item #71680-000790, List Price \$144.00 each).

### 3" DISC-KLEEN - LOW PRESSURE SPINE UPGRADE KIT

| ITEM NUMBER  | MODEL NUMBER       | DESCRIPTION                         | PRICE EACH |
|--------------|--------------------|-------------------------------------|------------|
| 70041-000573 | 25APKIT3DKLPSPINE3 | 3 Filter Complete Spine Upgrade Kit | \$ 940.00  |
| 70041-000574 | 25APKIT3DKLPSPINE4 | 4 Filter Complete Spine Upgrade Kit | \$1,235.00 |
| 70041-000575 | 25APKIT3DKLPSPINE5 | 5 Filter Complete Spine Upgrade Kit | \$1,530.00 |

For additional questions, contact your Netafim District Sales Manager or Customer Service at 888-638-2346.



5470 E. Home Ave.  
Fresno, CA 93727  
888.638.2346 • 559.453.6800  
FAX 800.695.4753  
www.netafimusa.com