

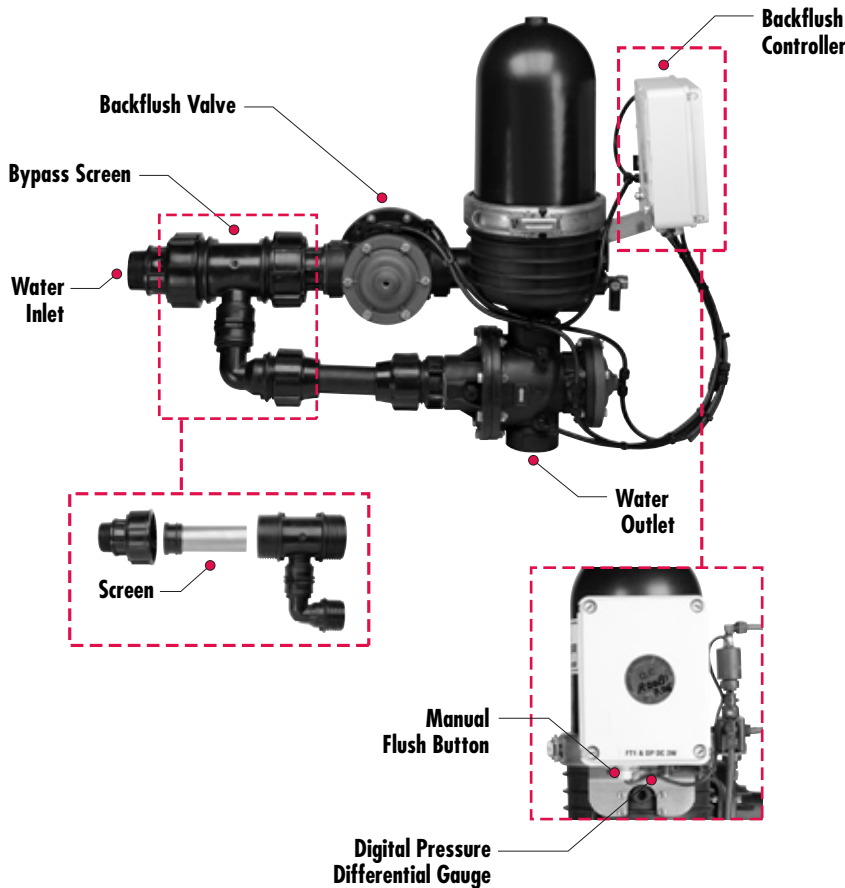

2" Compact Disc-Kleen Filter

Automatic Self-Cleaning Disc Filter for Low Flow Applications



Product Advantages

- Automatic self-cleaning filter for low volume capacity - 0 to 80 GPM.
- Constructed of the highest quality UV protected reinforced polymer plastic to prevent corrosion.
- Proven Disc-Kleen depth filter technology - filters through the entire ring depth and not just the surface.
- Built-in backflush controller functions by digital pressure differential gauge and/or time.
- No electricity needed - backflush controller operates on four "C" batteries.
- Backflush controller contains external button to initiate manual backflush cycle without opening controller.
- Standard with lightweight, corrosion-resistant plastic backflush valves.
- Easily accessible bypass screen filter ensures clean water for backflushing.
- Compact pre-assembled unit for easy installation - fits in tight spaces.



Applications

- Irrigation systems with a capacity of 0-80 GPM requiring clean water to operate drippers or micro-sprinklers in the Agriculture, Greenhouse and Nursery markets.
- For industrial use:
 - recycled water
 - water discharged from a plant
- For areas without electricity.
- When automation is desirable because manual cleaning is frequent and too cumbersome.
- Compact design fits in tight spaces.

Specifications

Inlet: 2" Male Pipe Thread
 Outlet: 2" Female Pipe Thread
 Flush Port: 2" Female Pipe Thread
 Maximum Operating Pressure: 140 psi
 Minimum Pressure for Backflush: 40 psi
 Minimum Flow for Backflush: 30 GPM
 Minimum Allowable pH: 5

2" COMPACT DISC-KLEEN FILTER Headloss

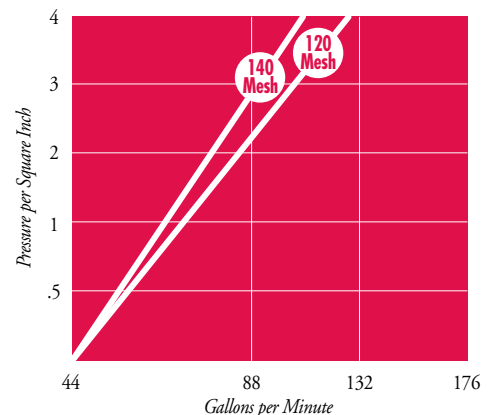

NETAFIM USA
 5470 E. Home Ave. • Fresno, CA 93727
 888.638.2346 • 559.453.6800
 FAX 800.695.4753
www.netafimusa.com

2" Compact Disc-Kleen Filter Technical Information

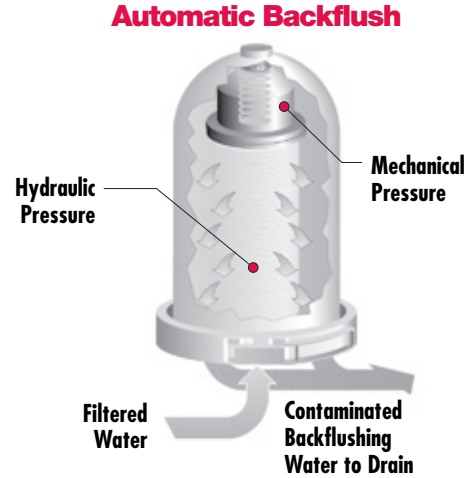
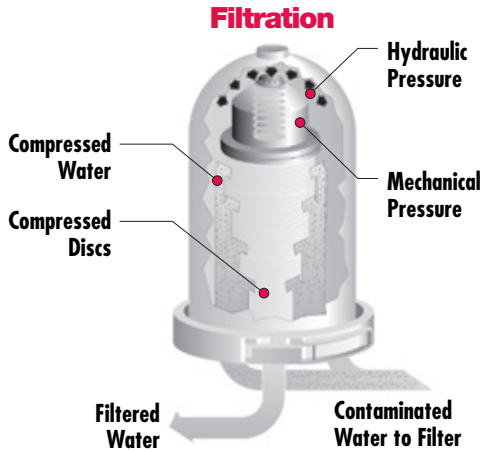

Description of Operation

- Contaminated water flows from the inlet manifold through the backflush valves and through the filter.
- Clean water exits the filter and flows through the outlet valve to the system.

Note: Inspect in-line screen on a regular basis, frequency is based on the quality of the water.

Automatic Backflush

- Pressure differential switch activates controller at 7 psi differential.
- Solenoid closes both valves.
- Water flows through the bypass filter to the spine in the reverse direction and separates the discs.
- Water jets spin and clean the discs.
- Dirty water discharges through the flush port.
- During flush time of 20 seconds, there is no flow to the field.

MODEL NUMBERS

Item Number	Model Number	Description
70641-007351	26ASK2A1T-120NEW	2" Compact 0-80 GPM 120 Mesh
70641-007451	26ASK2A1T-140NEW	2" Compact 0-80 GPM 140 Mesh
70641-007200	26ASK2A1TLF-120	2" Compact Low Flow 0-40 GPM 120 Mesh
70641-007250	26ASK2A1TLF-140	2" Compact Low Flow 0-40 GPM 140 Mesh

Materials

Flush valves: Plastic
 Seals: Nitrilo Rubber, EPDM
 Filter & Spine: Reinforced Polyamide
 Discs: Polypropylene
 Clamp & Screws: Stainless Steel

MAXIMUM FLOW RATE (GPM)

Water Quality	120 Mesh	140 Mesh
Good	80	70
Average	70	60
Poor	55	50
Very Poor	35	30

DIMENSIONS

Inlet / Outlet	Inlet / Outlet Offset	Overall	Weight (lbs. net)
21 1/2"	8 5/8"	30" x 25"	32

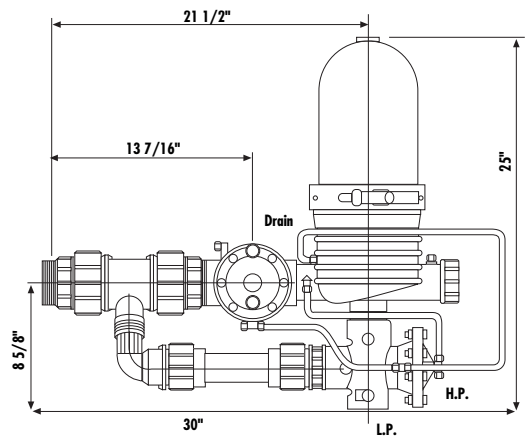

Netafim USA – Delivering Total System Solutions for Agriculture

- Dripperlines • Sprinklers • Filters • Valves • Air Vents • Flow Meters • Crop Management Technologies



For more information call your Authorized Netafim USA Distributor or call Netafim USA Customer Service at (888) 638-2346.