



Mine Lite™ Dripplerline

Non-Pressure Compensating Dripplerline – The Economical Solution for Mining Operations That Require a Low Application Rate and a Relatively Short Leach Time for Gold and Copper Mines

Industry's Widest Flow Path

Wider cross-section allows large particles through short flow path.

Advanced Flap Technology

Systematically opens and closes during start-up and shut-down providing uninterrupted flow while open and preventing soil ingestion and root intrusion when closed.

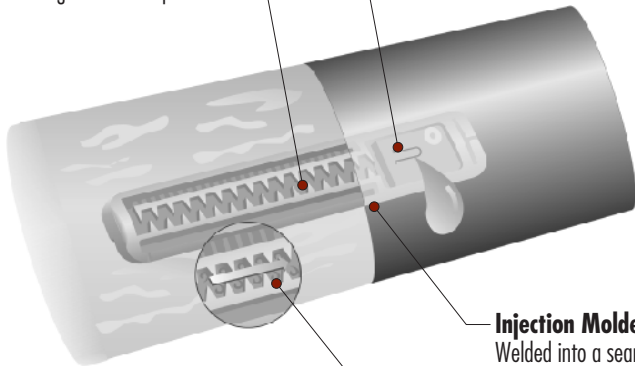

Injection Molded Drippers

Welded into a seamless wall of tubing for added strength, durability and long-term performance.

TURBONET

Increased Flow Path Velocity

Commonly used turbulent drippers have overlapping tooth patterns, easily catching debris.

Turbonet Technology improves dripper performance by widening the tooth pattern, maximizing flow path velocity, allowing contaminants to pass easily through the dripper, virtually eliminating plugging.

Product Advantages

- Injection Molded Drippers - welded into a wall of seamless tubing preventing damage to the drippers during installation and distortion of the dripper flow even as tubing stretches and expands.
- Seamless Construction
 - Stronger, more durable than comparable drippers
 - Fortifies against splitting or bursting under high pressures required for proper flushing
 - Eliminates root growth and intrusion - no path for roots to follow
- Dripplerlines packaged with more feet per reel, the industry's longest, requiring fewer fittings and less time changing reels during installation.
- Industry's lowest filtration requirement - 120 mesh.
- Larger filter inlets, provide secondary filtration - reduces clogging, maintaining the essential supply of water to the dripper for constant delivery of water flow.
- UV and acid resistant.

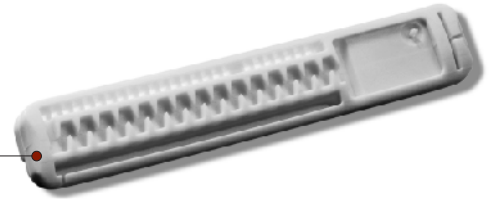

Applications

- On-surface or subsurface applications.
- Short term heap leach applications.

Specifications

Dripper flow rates (GPH): 0.6, 2.0

Common spacings: 18", 24", 30", 36", 42"

Non-pressure compensating

Wall thickness: 20 mil (also available in 15 mil and 25 mil)

Recommended filtration: 120 mesh

Inside diameter: 0.630

Reel length: 3,000"

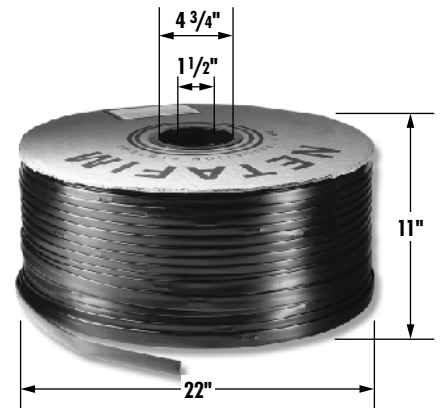

NETAFIM USA

5470 E. Home Ave. • Fresno, CA 93727

888.638.2346 • 559.453.6800

FAX 800.695.4753

www.netafimusa.com

Mine Lite™ Technical Information

MINE LITE Flow Rate vs. Pressure

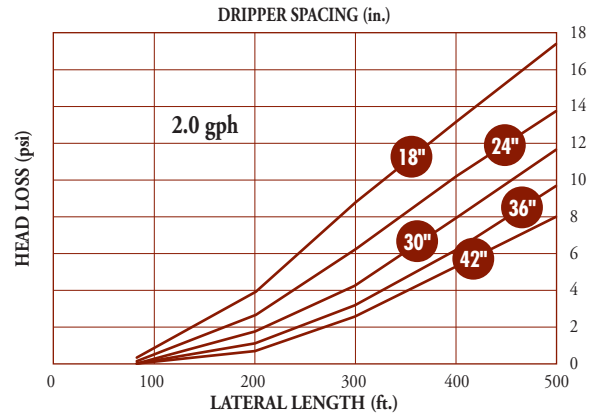
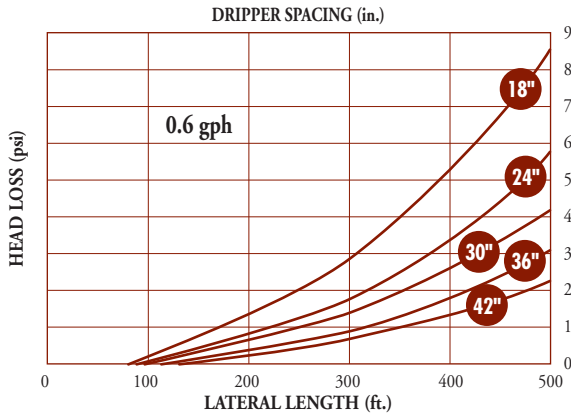

PACKAGING DATA

Wall	Reel Length	Weight	Reels per Pallet	Weight per Pallet
20 mil	3,000'	50 lbs	12	645 lbs

Packaging data using 22" x 11" cardboard reels with 1 1/2" hub hole.
Weights are approximate. Pallet weight includes 45 lbs. for weight of pallet.

DRIPPER DATA

Dripper GPH	Exponent (x)	Constant (k)	Kd (990)	Cv
0.6	0.48	0.188	0.1	.025
2.0	0.48	0.454	0.1	.025

DRIPPER FLOW PATH DIMENSIONS

Dripper	Length	Depth	Width
0.6	0.9"	0.034"	0.037"
2.0	0.87"	0.036"	0.059"

MAXIMUM OPERATING PRESSURE

Wall Thickness	psi
20 mil	20

Netafim USA - Delivering Total System Solutions for Mining

- Dripperlines • Filters • Valves • Air Vents • Sprinklers • Flow Meters

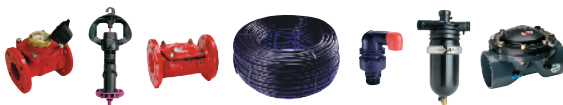

For more information call Netafim USA
Customer Service at (888) 638-2346.